

Outparcel Available

686 – 728 Cheney Highway
Titusville, Florida 32780



- Located at the Intersection of State Road 50 and Coquina Ave. ½ mile West of U.S. 1
- 73,594 Square Foot Newly Renovated Neighborhood Shopping Center
- Traffic Count: Over 27,500 Cars on State Road 50
- **Approximately 145.00' x 160.00'**



4280 Professional Center Drive, Suite 100 • Palm Beach Gardens • Florida 33410
(561) 966-0070 Phone • (561) 966-0260 Fax
www.nobleproperties.com

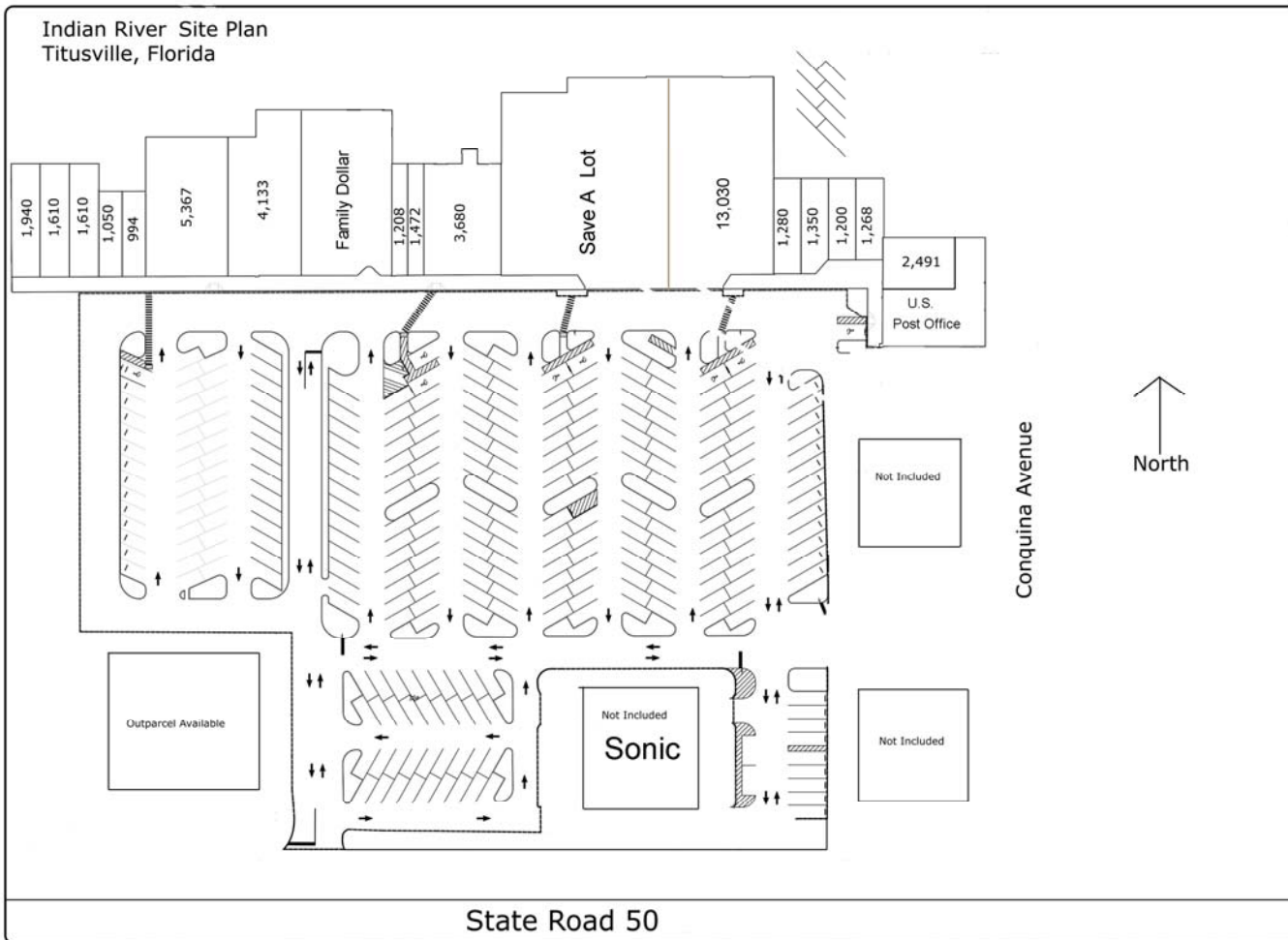

DEMOGRAPHICS:

	<u>3 Mile</u>	<u>5 Mile</u>
Estimated 2013 Population	29,011	44,476
Projected 2018 Population	29,060	45,549
Estimated 2013 Households	12,761	19,667
Projected 2018 Households	12,915	19,392
2013 Average Household Income	\$60,397	\$57,379
2013 Median Age	44.1	44.2

FOR LEASING INFORMATION:

CALL: (904) 923-1514

Sebastian M. Smith

Leasing Specialist
 Noble Properties
 4280 Professional Center Drive, Suite 100
 Palm Beach Gardens, FL 33410

Sebastian@noblep.com

